







2240D- TOUGH COVER * – High pressure hose



CONSTRUCTION Core tube : Polyoxymethylene
Pressure reinforcement :Two spiral layers of high tensile steel wire

Cover : Polyamide
Standard colour :blue

TEMPERATURE RANGE -10°C up to +70°C

#											
	DN	size	mm	inch	mm	MPa	psi	MPa	psi	mm	kg/m
2240D-02V32-TC	3	-02	3.0	1/8	7.0	110	15,950	275	39,875	60	0.07
2240D-025V32-TC	4	-025	4.0	5/32	7.7	120	17,400	300	43,500	75	0.10
2240D-03V32-TC	5	-03	4.8	3/16	9.5	100	14,500	250	36,250	95	0.13
2240D-04V32-TC	6	-04	6.4	1/4	11.5	110	15,950	275	39,875	110	0.20

NOTES * Non TOUGH COVER Versions available on request.

2248D- TOUGH COVER * – High pressure hose









CONSTRUCTION

Core tube : Polyoxymethylene
 Pressure reinforcement : Two spiral layers of high tensile steel wire
 Cover : Polyamide
 Standard colour : blue

TEMPERATURE RANGE

-10°C up to +70°C

#											
	DN	size	mm	inch	mm	MPa	psi	MPa	psi	mm	kg/m
2248D-025V32-TC	4	-025	4.0	5/32	7.9	150	21,750	375	54,375	75	0.10
2248D-03V32-TC	5	-03	4.9	3/16	9.5	140	20,300	350	50,750	95	0.14
2248D-05V32-TC	8	-05	8.1	5/16	13.4	100	14,500	250	36,250	120	0.25

NOTES

* Non TOUGH COVER Versions available on request.

Hoses with design factor >2:1
106TX – 1AYTX

106TX – JIC female swivel

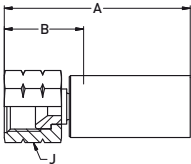

MATERIAL Carbon steel zinc plated

#						A					Nipple ID	Ferrule OD
	DN	size	mm	inch		mm	mm		MPa	psi	mm	mm
106TX-4-02W	3	-02	3.0	1/8	7/16-20 UNF	40	21	17	110	15,950	1.6	9.1
106TX-4-025W	4	-025	4.0	5/32	7/16-20 UNF	44	21	17	150	21,750	2.3	9.9
106TX-6-03W	5	-03	4.8	3/16	9/16-18 UNF	48	25	19	140	20,300	2.8	12.0
106TX-6-04W	6	-04	6.4	1/4	9/16-18 UNF	53	26	19	110	15,950	3.8	13.6

1AYTX – Type “M” female swivel

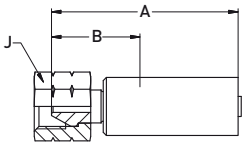

MATERIAL Carbon steel zinc plated

#						A					Nipple ID	Ferrule OD
	DN	size	mm	inch		mm	mm		MPa	psi	mm	mm
1AYTX-6-02W	3	-02	3.0	1/8	9/16-18 UNF	47	28	19	110	15,950	1.6	9.1
1AYTX-6-025W	4	-025	4.0	5/32	9/16-18 UNF	45	23	19	150	21,750	2.3	9.9
1AYTX-6-03W	5	-03	4.8	3/16	9/16-18 UNF	50	23	19	150	21,750	2.8	12.0
1AYTX-6-04W	6	-04	6.4	1/4	9/16-18 UNF	52	25	19	110	15,950	3.8	13.6
1AYTX-8-05W	8	-05	7.9	5/16	3/4-16 UNF	64	30	27	100	14,500	4.8	16.1

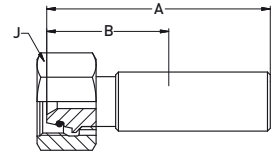
**1C9TX – Metric female swivel
heavy series with O-ring****MATERIAL** Carbon steel zinc plated**NOTE** * DN4-6 with support ferrule – DN3 and 8 without support ferrule

#						A	B				Nipple ID	Ferrule OD
	DN	size	mm	inch		mm	mm	mm	MPa	psi	mm	mm
1C9TX-16-02W	3	-02	3.0	1/8	M24x1.5	60	39	30	110	15,950	1.6	9.1
1C9TX-16-025W	4	-025	4.0	5/32	M24x1.5	66	35	30	150	21,750	2.3	9.9
1C9TX-16-03W	5	-03	4.8	3/16	M24x1.5	74	42	30	150	21,750	2.8	12.0
1C9TX-10-04W	6	-04	6.4	1/4	M18x1.5	60	33	22	110	15,950	3.8	13.6
1C9TX-16-04W	6	-04	6.4	1/4	M24x1.5	70	44	30	110	15,950	3.8	13.6
1C9TX-12-05W	8	-05	7.9	5/16	M20x1.5	70	31	24	100	14,500	4.8	16.1
1C9TX-14-05W	8	-05	7.9	5/16	M22x1.5	68	29	27	100	14,500	4.8	16.1
1C9TX-16-05W *	8	-05	7.9	5/16	M24x1.5	71	38	30	100	14,500	4.8	16.1

Design Factor >2:1

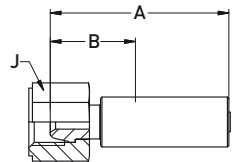
1U0TX – BSP female swivel (ballnose)**MATERIAL** Carbon steel zinc plated

#						A	B				Nipple ID	Ferrule OD
	DN	size	mm	inch		mm	mm	mm	MPa	psi	mm	mm
1U0TX-2-02W	3	-02	3.0	1/8	G 1/8	36	18	12	110	15,950	1.6	9.1
1U0TX-4-02W	3	-02	3.0	1/8	G 1/4	44	22	17	110	15,950	1.6	9.1
1U0TX-4-025W	4	-025	4.0	5/32	G 1/4	45	23	17	150	21,750	2.3	9.9
1U0TX-4-03W	5	-03	4.7	3/16	G 1/4	49	23	17	150	21,750	2.8	12.0
1U0TX-4-04W	6	-04	6.3	1/4	G 1/4	51	25	17	110	15,950	3.8	13.6
1U0TX-6-05W	8	-05	7.9	5/16	G 3/8	60	26	27	100	14,500	4.8	16.1

Hoses with design factor >2:1

101TX – 102TX

101TX – National Pipe Tapered (NPT) male

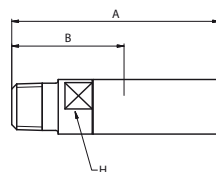

MATERIAL Carbon steel zinc plated

#						A	B				Nipple ID	Ferrule OD
	DN	size	mm	inch		mm	mm		MPa	psi	mm	mm
101TX-1-02W	3	-02	3.0	1/8	1/16 NPT	46	25	10	103.4	15,000	1.6	9.1
101TX-2-02W	3	-02	3.0	1/8	1/8 NPT	44	22	10	103.4	15,000	1.6	9.1
101TX-1-025W	4	-025	4.0	5/32	1/16 NPT	47	25	10	150.0	21,750	2.3	9.9
101TX-2-025W	4	-025	4.0	5/32	1/8 NPT	49	27	10	150.0	21,750	2.3	9.9
101TX-4-025W	4	-025	4.0	5/32	1/4 NPT	56	34	13	150.0	21,750	2.3	9.9
101TX-2-03W	5	-03	4.8	3/16	1/8 NPT	54	27	10	140.0	20,300	2.8	12.0
101TX-4-03W	5	-03	4.8	3/16	1/4 NPT	61	34	13	140.0	20,300	2.8	12.0
101TX-4-04W	6	-04	6.4	1/4	1/4 NPT	62	35	13	140.0	20,300	3.8	13.6
101TX-4-05W	8	-05	7.9	5/16	1/4 NPT	69	35	13	103.4	15,000	4.8	16.1
101TX-6-05W	8	-05	7.9	5/16	3/8 NPT	69	35	17	103.4	15,000	4.8	16.1

102TX – National Pipe Tapered (NPT) female

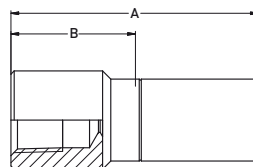

MATERIAL Carbon steel zinc plated

#						A	B	R			Nipple ID	Ferrule OD
	DN	size	mm	inch		mm	mm	mm	MPa	psi	mm	mm
102TX-1-025W	4	-025	4.0	5/32	1/16 NPT	45	23	12	103.4	15,000	2.3	9.9
102TX-2-03W	5	-03	4.8	3/16	1/8 NPT	50	23	14	103.4	15,000	2.8	12.0
102TX-4-04W	6	-04	6.4	1/4	1/4 NPT	56	29	19	103.4	15,000	3.8	13.6

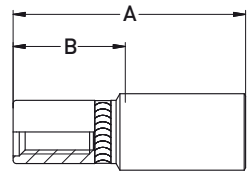
**6HYPL – Left hand female
for water jetting nozzle****MATERIAL** Carbon steel zinc plated**NOTE** * ProLance fitting; only for 2240D

#						A		B	R			Nipple ID	Ferrule OD
	DN	size	mm	inch		mm	mm	mm	mm	MPa	psi	mm	mm
6HYPL-1-2*	3	-02	3.0	1/8	12 - 28 UNF	29	13	10	103.4	15,000	1.6	8.4	

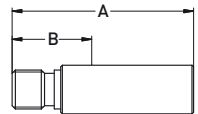
63ZPL / 6ZEPL – Male water jetting nozzle**MATERIAL** Carbon steel zinc plated, C: Stainless steel**NOTE** * ProLance fitting; only for 2240D

#						A		B	R			Nipple ID	Ferrule OD
	DN	size	mm	inch		mm	mm	mm	mm	MPa	psi	mm	mm
63ZPL-5-2A*	3	-02	3.0	1/8	5/16 - 32 UNF	28	11	11	103.4	15,000	2.5	10.1	
6ZEPL-5-2A*	3	-02	3.0	1/8	5/16 - 24 UNF	33	18	11	103.4	15,000	2.5	10.1	
63ZPL-5-3*	5	-03	4.8	3/16	5/16 - 32 UNF	33	13	13	103.4	15,000	3.2	11.7	
63ZPL-5-3C*	5	-03	4.8	3/16	5/16 - 32 UNF	34	9	14	103.4	15,000	3.2	11.7	
63ZPL-5-4C*	6	-04	6.4	1/4	5/16 - 32 UNF	71	11	17	103.4	15,000	3.2	13.2	

Hoses with design factor >2:1
6EZPL – 1YZTX

6EZPL – Female water jetting nozzle

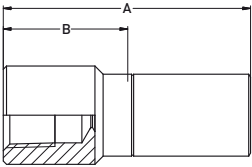

MATERIAL Carbon steel zinc plated
NOTE * ProLance fitting; only for 2240D

#						A	B	R			Nipple ID	Ferrule OD
	DN	size	mm	inch		mm	mm	mm	MPa	psi	mm	mm
6EZPL-1-2A*	3	-02	3.0	1/8	12 - 28 UNF	33	17	11	103.4	15,000	2.5	10.1
6EZPL-5-2A*	3	-02	3.0	1/8	5/16 - 24 UNF	38	23	11	103.4	15,000	2.5	10.1

1YZTX – Metric male nozzle nipple

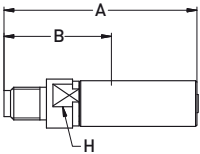

MATERIAL Carbon steel zinc plated

#						A	B				Nipple ID	Ferrule OD
	DN	size	mm	inch		mm	mm	mm	MPa	psi	mm	mm
1YZTX-1-02WS	3	-02	3.0	1/8	M5	49	28	6	110	15,950	1.6	9.1
1YZTX-2-02W	3	-02	3.0	1/8	M7	49	28	7	110	15,950	1.6	9.1
1YZTX-1-025W	4	-025	4.0	5/32	M5	51	29	8	150	21,750	2.3	9.9
1YZTX-2-025W	4	-025	4.0	5/32	M7	51	29	8	150	21,750	2.3	9.9
1YZTX-4-025W	4	-025	4.0	5/32	M8	53	30	8	150	21,750	2.3	9.9
1YZTX-5-025W	4	-025	4.0	5/32	M10x1	52	30	8	150	21,750	2.3	9.9
1YZTX-2-03W	5	-03	4.8	3/16	M7	55	28	10	150	21,750	2.8	12.0
1YZTX-4-03W	5	-03	4.8	3/16	M8	53	28	10	150	21,750	2.8	12.0
1YZTX-5-04W	6	-04	6.4	1/4	M10x1	59	33	13	110	15,950	3.8	13.6
1YZTX-5-05W	8	-05	7.9	5/16	M10x1	68	34	13	100	14,500	4.8	16.1

7/8- 2015-11-09 CONDIÇÕES GERAIS DE COMERCIALIZAÇÃO EM WWW.HTUBO.PT/EMPRESA



1YBTX – BSP male nozzle nipple

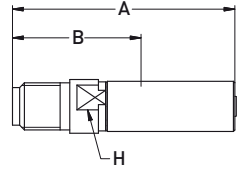

MATERIAL Carbon steel zinc plated

#						A	B				Nipple ID	Ferrule OD
	DN	size	mm	inch		mm	mm		MPa	psi	mm	mm
1YBTX-2-02W	3	-02	3.0	1/8	G 1/8	48	27	8	110	15,950	1.6	9.1
1YBTX-2-025W	4	-025	4.0	5/32	G 1/8	53	30	8	150	21,750	2.3	9.9
1YBTX-4-025W	4	-025	4.0	5/32	G 1/4	54	30	10	150	21,750	2.3	9.9
1YBTX-2-03W	5	-03	4.8	3/16	G 1/8	53	27	10	150	21,750	2.8	12.0
1YBTX-4-03W	5	-03	4.8	3/16	G 1/4	58	31	10	150	21,750	2.8	12.0
1YBTX-2-04W	6	-04	6.4	1/4	G 1/8	60	33	10	110	15,950	3.8	13.6
1YBTX-4-04W	6	-04	6.4	1/4	G 1/4	62	36	10	110	15,950	3.8	13.6
1YBTX-4-05W	8	-05	7.9	5/16	G 1/4	68	35	13	100	14,500	4.8	16.1
1YBTX-6-05W	8	-05	7.9	5/16	G 3/8	71	37	17	100	14,500	4.8	16.1

1YHTX – BSP male nozzle nipple

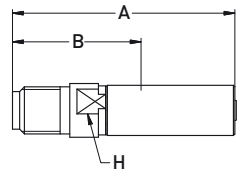

MATERIAL Carbon steel zinc plated

#						A	B				Nipple ID	Ferrule OD
	DN	size	mm	inch		mm	mm		MPa	psi	mm	mm
1YHTX-4-025W	4	-025	4.0	5/32	1/4 - 28 UNF	47	23	8	150	21,750	2.3	9.9
1YHTX-4-025W-LH	4	-025	4.0	5/32	1/4 - 28 UNF LH	47	23	8	150	21,750	2.3	9.9
1YHTX-6-03W	5	-03	4.8	3/16	3/8 - 24 UNF	54	28	11	150	21,750	2.8	12.0
1YHTX-6-03W-LH	5	-03	4.8	3/16	3/8 - 24 UNF LH	54	28	11	150	21,750	2.8	12.0
1YHTX-6-04W	6	-04	6.4	1/4	3/8 - 24 UNF	56	29	11	150	21,750	3.8	13.6
1YHTX-6-04W-LH	6	-04	6.4	1/4	3/8 - 24 UNF LH	56	29	11	150	21,750	3.8	13.6
1YHTX-6-05W	8	-05	7.9	5/16	3/8 - 24 UNF	65	33	13	150	21,750	4.8	16.1
1YHTX-6-05W-LH	8	-05	7.9	5/16	3/8 - 24 UNF LH	65	33	13	150	21,750	4.8	16.1